

Your partner in building solutions



## INSTALLATION GUIDE



**Ceilings**



© PBS Distributors. The content of these instructions remain the property of PBS Distributors and must not be altered, used or any other publication without the written permission of PBS Distributors.

TE-SY-CE-Install 110715

## General remarks on Eterpan Ceilings

- This installation guide is to be used in conjunction with:
  - PBS Eterpan Soffit & Ceiling Q & A Sheet
  - PBS Ceiling Linings specifications
  - PBS Ceilings Linings Order List
  - Architects' specific details
  - PBS Corporate Folder
  
- The methods selected for this guide are based on experience from sites & have proven to give the best results. The sequence of the work steps as well as their implementation may vary more or less due to different building situations.
  
- Further details are available in the PBS folder or from the website

[www.pbs.co.nz](http://www.pbs.co.nz)



# eterpan

## Soffit Quality Assurance Check Sheet

### IMPORTANT NOTES:

All sections of this check sheet shall be completed in full.  
 Refer to PBS technical details and installation guidelines at all times for completing Eterpan Soffit construction.  
 All construction shall comply with the requirements of the NZ building code.

<b>Project:</b>	Eterpan Soffits; 4.5mm / 6.0mm / 7.5mm / 9.0mm thick	O.K. ✓	Req'd ✓	Re Check	O.K. ✓	Re Check	Date of O.K.
<b>Operation:</b>	Feb-11						
<b>Revision:</b>							
<b>Work Sequence</b>	<b>Level/Zone:</b>	Note: N/A – not applicable					
<b>Vent/Cad</b>	<b>FRAMING CHECKS</b>						
<b>1.0</b>	1.1 Moisture content of framing no greater than 16%.						
	1.2 Soffits to be supported all four edges by ribbon boards, fascias and noggs.						
	1.3 Check alignment i.e. Studs & noggs straight and true						
	1.4 Check for 70mm wide framing to all expressed joints						
	1.5 Check for double frame with 10mm gap for control joints						
<b>2.0</b>	<b>FRAMING CENTRES</b>						
	<b>Nogging Centres</b>						
	2.1 450 & 600mm soffit width max. nogging ctrs @ 1200mm						
	2.2 750mm soffit width max. nogging ctrs @ 900mm						
	2.3 900 & 1200mm soffit width max. nogging ctrs @ 600mm						
<b>3.0</b>	<b>ROOF &amp; DECK</b>						
	3.1 Ensure roof or deck above is watertight before fixing soffits						
<b>4.0</b>	<b>EXPRESSED JOINT SOFFITS</b>						
	4.1 Fixing with 8G x 40.0mm S.S countersunk screws						
	4.1.1 Edge distances: min 15.0mm						
	Corner distances: min 100 & 50						
	4.2 Fixed @ 200 ctrs to perimeter and noggs						
	<b>Expressed Joints</b>						
	4.3 Backed with foam tapes						
	4.4 Backed with aluminium sockets						
<b>5.0</b>	<b>FLUSH JOINT SOFFITS</b>						
	5.1 Fixing with 2.8 x 40.0mm S.S angular grooved clouits						
	5.1.1 Edge distances: min 15.0mm						
	Corner distances: min 100 & 50						
	5.2 Fixed @ 200 ctrs to perimeter and noggs						
	<b>Sheet Layout</b>						
	5.3 Stagger joints						
	5.4 Fix from centre out						
	<b>Control Joints</b>						
	5.5 Use PVC control joint extrusions						
	5.6 Max bay size 9 metres x 6 metres						
	5.7 Provide at changes in direction						
<b>6.0</b>	<b>PVC JOINT SOFFITS</b>						
	6.1 Fixing with 2.8 x 40.0mm S.S angular grooved clouits						
	6.1.1 Edge distances: min 15.0mm						
	Corner distances: min 100 & 50						
	6.2 Fixed @ 200 ctrs to perimeter and noggs						
	<b>PVC Joiners</b>						
	6.3 4.5mm, 6.0mm, 7.5mm or 9.0mm PVC mouldings at joints						



# eterpan

## Soffit Quality Assurance Check Sheet

<b>Project:</b>	Eterpan Soffits: 4.5mm / 6.0mm / 7.5mm / 9.0mm thick			
<b>Operation:</b>	Feb-11			
<b>Revision:</b>				
<b>Work Sequence</b>	<b>Level/Zone</b>	<b>O.K</b>	<b>Rec'd</b>	<b>Re Check</b>
<b>7.0</b>	<b>SCREW/HOLE STOPPING</b>	<b>O.K</b> ✓	<b>✓</b>	<b>O.K</b> ✓
	7.1 Clean & prime holes			
	7.2 Fill with Nuplex Farring cream & scrape flush			
	7.3 Flush off with Eterstop compound			
	7.4 Sand smooth			
<b>8.0</b>	<b>PLASTERING</b>			
	8.1 HIT PVC control joints			
	8.2 Clean sheets & prime surfaces			
	8.3 Apply jointing mesh			
	8.4 Apply jointing compound			
	8.5 Sand flush			
	8.6 Apply 3 coat paint system			
<b>SIGN OFF QUALITY ASSURANCE SHEET:-</b>		<b>Date</b>		
<b>REQUEST FOR PRODUCER STATEMENT</b>				
<b>Site Address:-</b>	_____			
	_____			
	_____			
<b>Building Consent No:-</b>	_____			
<b>Territorial Authority:-</b>	_____			
<b>Fixer/ Builder</b>	_____			
<b>Trading Name:-</b>	_____			
<b>Contact Name:-</b>	_____			
<b>Postal Address:-</b>	_____			
<b>Contact Details:-</b>	_____			
<b>Phone:-</b>	_____			
<b>Fax:-</b>	_____			
<b>Mobile:-</b>	_____			
<b>E-mail:-</b>	_____			
	<b>Date:</b>	_____		

*Please note all Producer Statement requests must be completed and signed by fixer/ builder or a nominated company representative.*

## Preliminary checks

- Ensure that new / existing support framing is suitable.
  - NZS3602 “Timber and wood-based products for use in buildings” for timber treatment allowable moisture content
  - NZS 3603 “Timber structure standard” and AS/NZS 1170 “Structural design actions” structural and design OR
  - NZS 3604 “Timber framed buildings”
- Ceiling sheets to be supported on four edges.
- Complete frame check to ensure compliance. Nogs to be as per table below.

SHEET WIDTH mm	MAX. SOFFIT NOG CTRS. mm
450, 600	1200
750	900
900, 1200	600

- Ensure roof or deck above is watertight before fixing Ceiling linings.
- Ensure Eterpan sheet is stored flat on a flat surface, covered and kept dry.

## Products

- Eterpan Refined & Europan for **Ceilings**
- For exposed fixings use 40mm x 10g SS screws with 10g cup head washers. Or No 8 x 40mm Surefast screws for countersunk fixings.
- 40 x 2.8mm SS clouts, available in 5kg packs.
- Bostik SAFESEAL Sealant, available in 330 ml cartridge or 600 ml sausage
- PE Foam tape, 48mm x 1.6mm
- Aluminum sockets 0.7mm x 70mm, with 9 x 6mm Foam tapes
- 70mm x 30m roll PVC Duct tape. For separation between dissimilar materials.
- 3m PVC Joint mouldings in 4.5mm, 6.0mm, 7.5mm & 9.0mm sizes.

## Step 1: sheet fixing layout – FLUSH JOINTS

- ❑ Sheets to have stagger joints. **Refer diagram below**
- ❑ Fix sheets from centre out
- ❑ Control joints; Max bay size 9m x 6m. **Refer diagram below**
- ❑ Control joints required at changes in direction
- ❑ Control joints required to coincide with seismic or construction joints.
- ❑ All edges of the sheets have to be supported by a joist or nogg.

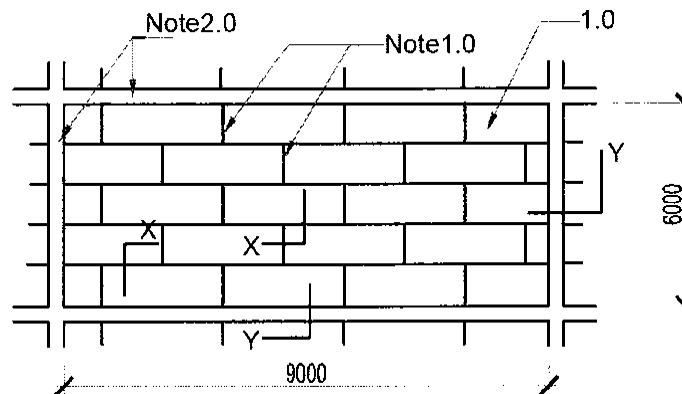
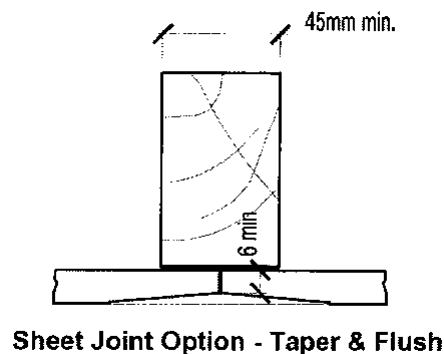

Notes:  
1. Stagger Sheet Joints.  
2. Control Joints.  
See section X-X & Y-Y on page EP.7.1.06.

## Step 2: sheet fixing layout – EXPRESSED JOINTS

- No specific sheet lay out required for expressed joints.
- Fix sheets from centre out
- For timber framing min. 70mm wide timber required for expressed joints
- For metal channel framing, two channels required for expressed joints.
- Expressed joints required at changes in direction
- All edges of the sheets have to be supported by a joist or nogg.

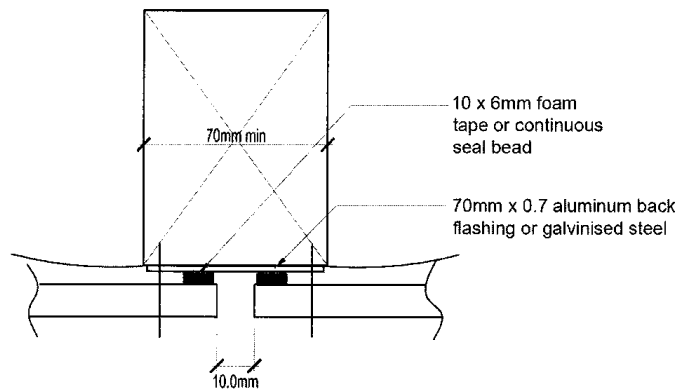

Detail A: Expressed Joint Timber Frame  
Section X & Y

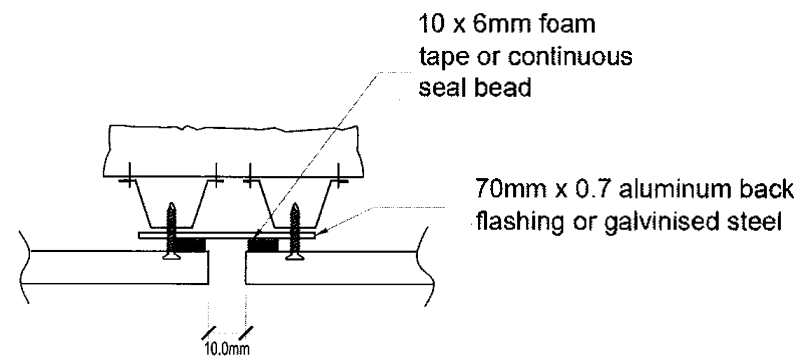

Detail A: Expressed Joint Metal Channel  
Section X & Y

## Step 3: Further sheet joint options

### PVC jointers

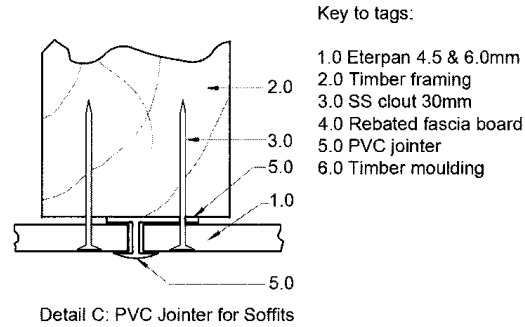

### Butt joint

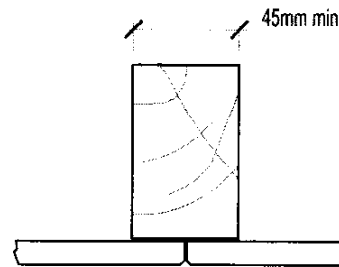

Sheet Joint Option - Butt Join

### Cover batten

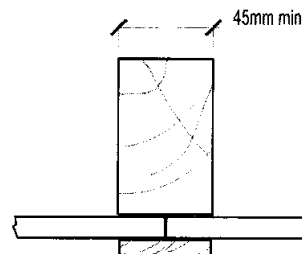

Sheet Joint Option - Cover Batten

## Step 12: Fix Sheets

- ❑ Cut Eterpan Refined, drill & countersink holes for screw fixed applications.
- ❑ Screw or clout fix Eterpan sheets @ max. 200mm crs to timber framing.
- ❑ Ensure minimum edge clearance of 12 mm for screw fixing of the sheets .
- ❑ Contact adhesive can be used to intermediate nogs instead of screws.

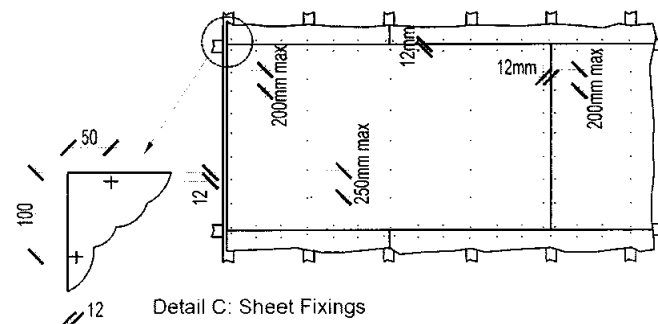
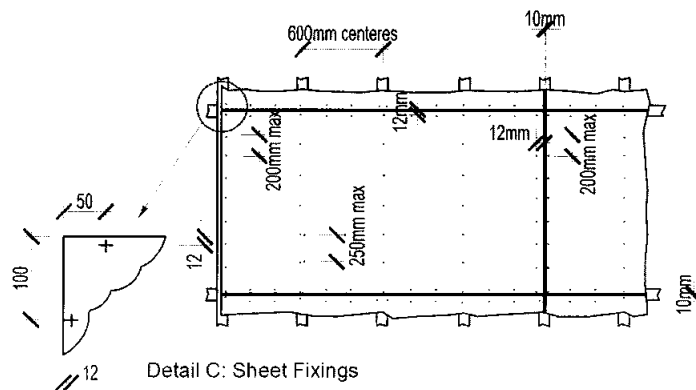

## Step 13: Finishing

- Clean & prime screw holes ready for filling.
- Fill screw holes with Nuplex Epoxy Furring cream and scrape flush. **(Dont over apply Epoxy)**
- Flush off with Eterstop/PAL external contract filler.
- Sand screw holes smooth and flush
- Complete Q A sheet to confirm compliance
- Plaster finishing to joints with Eterstop joint flushing and finishing compound
- Use paper joining tapes for internal applications and mesh tapes for external soffits